

## AXOR Citterio E

Bath thermostat for exposed installation

Surfaces: **Chrome** Article Number: **36140000**



### Description

#### product features

- projection 177 mm
- 2 outlets
- will not run two outlets at same time
- centre distance:  $150 \pm 16$  mm
- spray type mixer: normal spray
- flow rate: 20 l/min
- thermostat cartridge, shut-off/ diverter valve
- min. operating pressure: 1 bar
- max. operating pressure: 10 bar
- safety lock at  $40^\circ$  C
- temperature limitation adjustable
- non-return valve
- with silencer
- connection type: s-shaped connections
- connection dimension: DN15

### Technology



### Product image



### Scale drawing

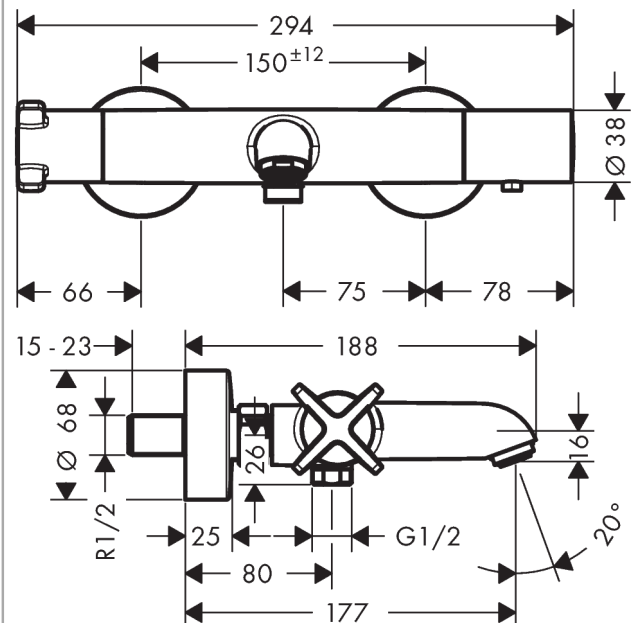

**AXOR Citterio E**  
**Bath thermostat for exposed installation**  
 Surfaces: **Chrome** Article Number: **36140000**



### Flowchart

